



Phone: 503.257.6604

Fax: 503.253.6564

DANA 60 ORDER FORM

By submitting this form, customer agrees to the current Terms, Conditions, & Policies as stated in the DMI price sheets & web site

SOLD / BILL TO:	SHIP TO:
Name _____	Name _____
Company _____	Company _____
Address _____	Address _____
City _____ State _____ Zip _____	City _____ State _____ Zip _____

DAY PHONE () _____ EVE PHONE () _____

FAX () _____ Email: _____ @ _____

Rear Style / Description: **Price:**

D60 housing & axles, un-assembled _____

D60 housing & axles, assembled _____

D60 with brkts. for GMA-Body, un-assembled _____

D60 with brkts. for GMA-Body, assembled _____

NOTE:

Un-Assembled = NO gears or differential

Assembled = Clutch style Trac-Loc posi, 3.54, 4.10, or 4.56 ratio choice, forged 1350 yoke, & a chrome cover.

Options:

3.73, 4.30, or 4.88 ratio choice surcharge _____

Tru Trac gear type posi _____

Detroit Locker posi _____

Full spool, 35 spline _____

LPW Aluminum support cover _____

Extra Bolt Pattern _____

*Access Holes in axle flange _____

*Required if Explorer or Wilwood disc with internal park brake.

Vehicle: _____

Engine: _____ Tranny: _____ Stall: _____ Trans Brake

Blower Nitrous, HP: _____ Torque: _____ Ratio: _____

Street Strip Roadrace/circle track Offroad

Show only Non performance Mild perf. Hi perf.

Brake Kits & Options: **Price:**

DMI Drum kit _____

Explorer disc kit _____

Wilwood disc kit _____

Solid rotor Vented rotor _____

Plain rotor Drilled/slotted/E-Coated rotors _____

No E-Brake E-Brake _____

Plain calipers Polished calipers _____

Baer disc kit _____

Plain rotor Drilled/slotted/zinc rotor _____

Plain calipers Polished calipers _____

-If **you are** supplying your own brake kit, check with us 1st to see if we have the build info for your brake kit. If we don't, you will need to answer the following to the best of your knowledge.

Manufacturers name and/or model # _____

Center hole in drum or rotor _____

Flange OD _____

Housing end your brake kit was designed for (from chart)

Small Ford, Big Ford-Old, Big Ford-New

If other, List style or dimensions _____

Brake offset from housing flange to axle flange _____

Office use only: \$ Advance: _____ Rec# _____

Cash Check Money Order Cashiers / Certified

Salesman: _____ Zone: _____ PP# _____

Name: _____

Date: _____

Attn: _____

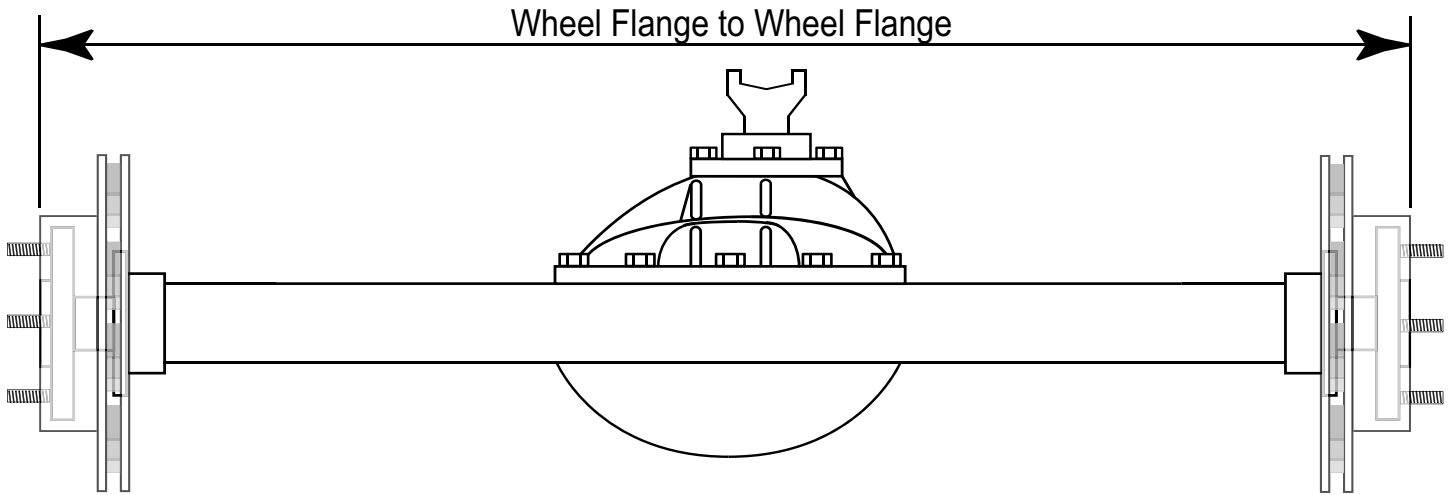

Desired width: _____

-This is to the **wheel** mounting faces & **includes** the thickness of the drums or rotors.

Centered Pinion Centered Housing _____

Bolt pattern(s): _____ studs on a _____ diameter bolt circle.

-Optional 2nd pattern: _____ studs on a _____ diameter bolt circle.

Optional Access Holes

Studs: 7/16" 1/2" 5/8" Metric _____ mm x _____ pitch

-Length: Stock Length - press in Extra Long - screw in (1/2" only)
 2" 3"

Brackets: If wanting spring perches (leaf spring cars) or brackets welded on, list the details below;

- Customer doing own
- Customer supplied
- Dutchman supplied
- Leaf spring perches
 - 2" 2 1/2" _____
 - GM Mono leaf _____
 - GM Multi leaf _____
- Brackets installed _____
- Brackets loose _____
- Brackets slid on tubes - left loose
- Cut-N-Call

Bracket center to center _____

Under Top of Housing

Pinion angle _____

Notes _____

Subtotal _____

Shipping _____

Total _____

Customer ok:

Bolt Pattern Measuring

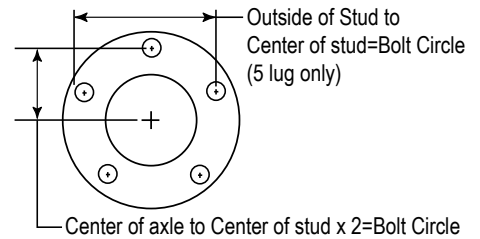

POB-Housing End Identifier

Big Ford-New Style

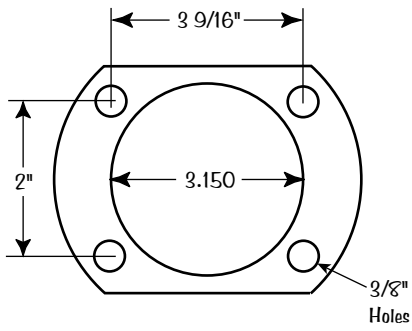

Big Ford-Old Style

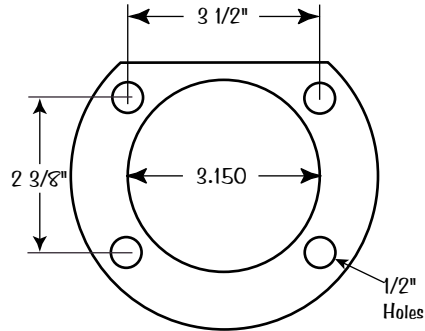

Small Ford

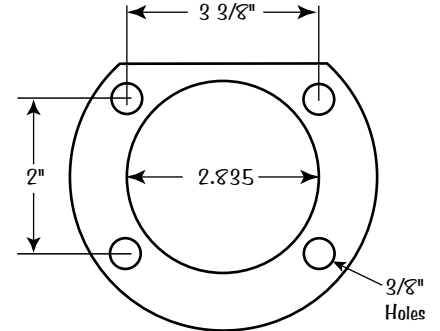

Mopar 8 3/4

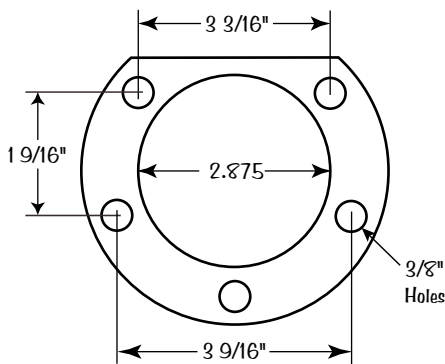

57-64 Olds/Pontiac

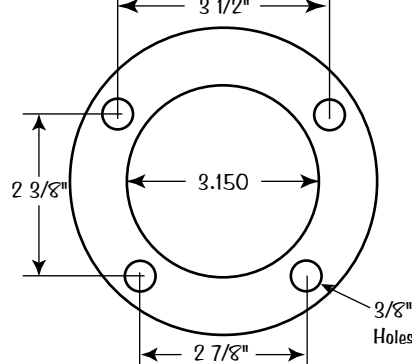

64 & up Buick/Olds/Pontiac

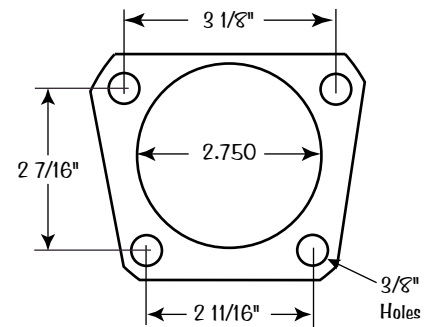

TJ

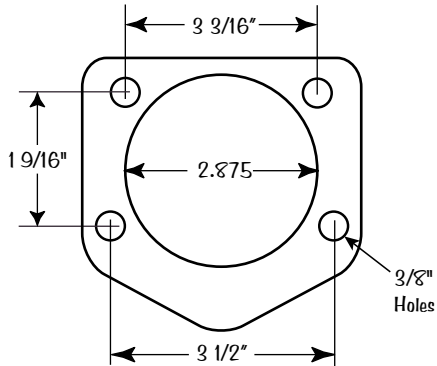

Jeep CJ

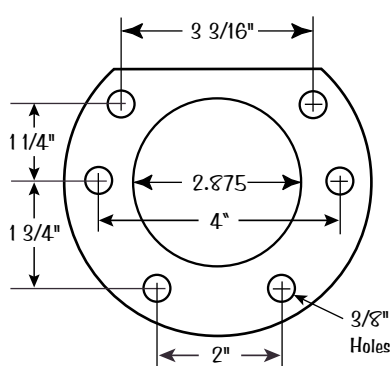

Wagoneer / YJ

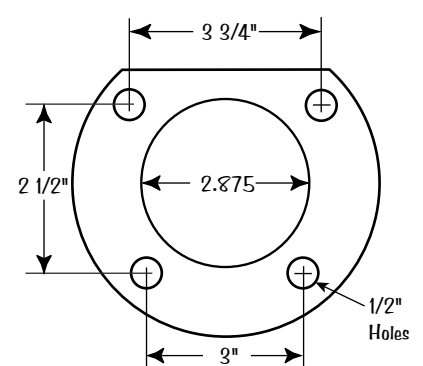

55-56 Chevy Belair

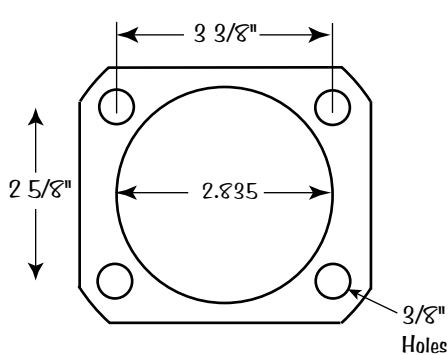

57-64 Chevy Belair/Impala

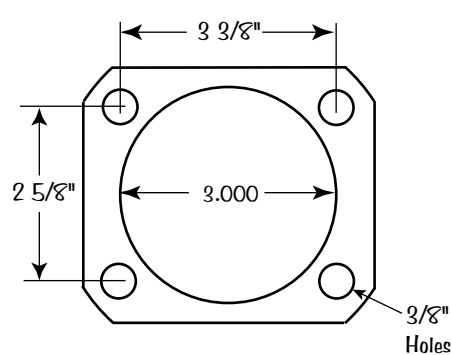

Wagoneer

