



Phone: 503.257.6604

Fax: 503.253.6564

9" FORD ORDER FORM

By submitting this form, customer agrees to the current Terms, Conditions, & Policies as stated in the DMI price sheets & web site

SOLD / BILL TO:	SHIP TO:
Name _____	Name _____
Company _____	Company _____
Address _____	Address _____
City _____ State _____ Zip _____	City _____ State _____ Zip _____

DAY PHONE () _____ EVE PHONE () _____

FAX () _____ Email: _____ @ _____

Rear Style / Description: **Price:**

Roadster Round Back _____

HD Street & Strip _____

HD Street & Strip w/brkts for 59-64 Impalas _____

Fab 9 _____

Fab 9 with brackets for GM A-Body _____

Fab 9 with brackets for GM G-Body _____

Polished Aluminum _____

Options:

Install back brace (all except aluminum) _____

Back brace loose (all except aluminum) _____

Install drain (Round back or HD SS) _____

Install econo filler (Round back or HD SS) _____

Install deluxe filler (Round back or HD SS) _____

Extra Bolt Pattern _____

*Access Holes in axle flange _____

*Required if Explorer or Wilwood disc with internal park brake.

Brake Kits & Options: **Price:**

DMI Drum kit _____

Explorer disc kit _____

Wilwood disc kit _____

Solid rotor Vented rotor _____

Plain rotor Drilled/slotted/E-Coat rotors _____

No E-Brake E-Brake _____

Plain calipers Polished calipers _____

Baer disc kit _____

Plain rotor Drilled/slotted/zinc rotor _____

Plain calipers Polished calipers _____

-If **you are** supplying your own brake kit, check with us 1st to see if we have the build info for your brake kit. If we don't, you will need to answer the following to the best of your knowledge.

Manufacturers name and/or model # _____

Center hole in drum or rotor _____

Flange OD _____

Housing end your brake kit was designed for (from chart)

Small Ford, Big Ford-Old, Big Ford-New

If other, List style or dimensions _____

Brake offset from housing flange to axle flange _____

Vehicle: _____

Engine: _____ Tranny: _____ Stall: _____ Trans Brake

Blower Nitrous, HP: _____ Torque: _____ Ratio: _____

Street Strip Roadrace/circle track Offroad

Show only Non performance Mild perf. Hi perf.

Office use only: \$ Advance: _____ Rec# _____

Cash Check Money Order Cashiers / Certified

Salesman: _____ Zone: _____ PP# _____

Name: _____

Date: _____

Attn: _____

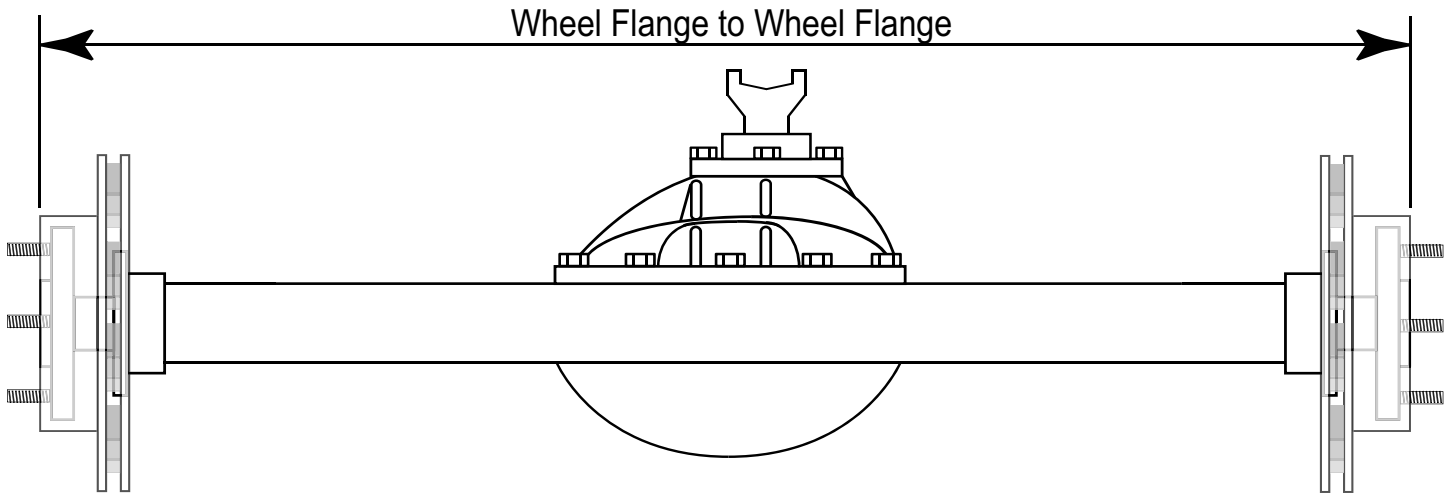

Desired width: _____

-This is to the **wheel** mounting faces & **includes** the thickness of the drums or rotors.

Centered Pinion Centered Housing _____

Bolt pattern(s): _____ studs on a _____ diameter bolt circle.

-Optional 2nd pattern: _____ studs on a _____ diameter bolt circle.

Optional Access Holes

Studs: 7/16" 1/2" 5/8" Metric _____ mm x _____ pitch

-Length: Stock Length - press in Extra Long - screw in (1/2" only)
 2" 3"

Brackets: If wanting spring perches (leaf spring cars) or brackets welded on, list the details below;

- Customer doing own
- Customer supplied
- Dutchman supplied
- Leaf spring perches
 - 2" 2 1/2" _____
 - GM Mono leaf _____
 - GM Multi leaf _____
- Brackets installed _____
- Brackets loose _____
- Brackets slid on tubes - left loose
- Cut-N-Call

Bracket center to center _____

Under Top of Housing

Pinion angle _____

Notes _____

Subtotal _____

Shipping _____

Total _____

Customer ok:

Bolt Pattern Measuring

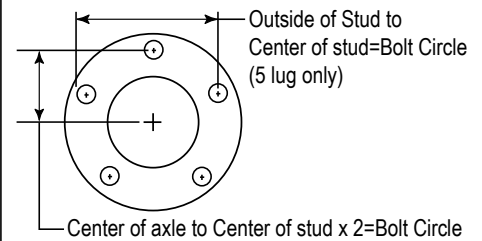

3rd member:

Price:

-If not ordering a 3rd member, how many splines does yours have? _____

Street _____

TruTrac TracLoc D. Locker

Street Plus _____

TruTrac TracLoc D. Locker

Pro Street _____

TruTrac Trac Loc

D. Locker Lenco Locker

Full Race _____

Aluminum _____

Plain Polished

TruTrac Trac Loc

Ratio: _____ Splines: _____

3.00 or 3.25 ratio surcharge _____

Double lapped gear surcharge _____

POB-Housing End Identifier

Big Ford-New Style

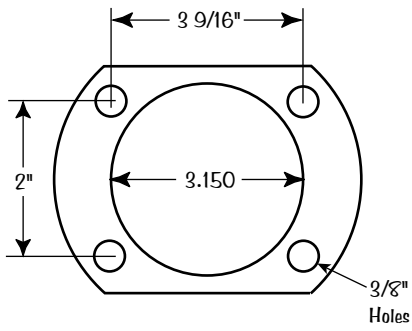

Big Ford-Old Style

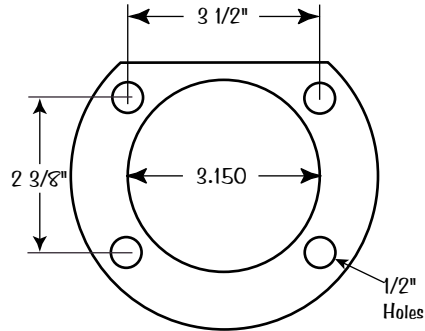

Small Ford

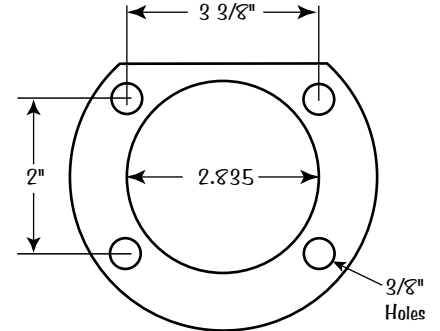

Mopar 8 3/4

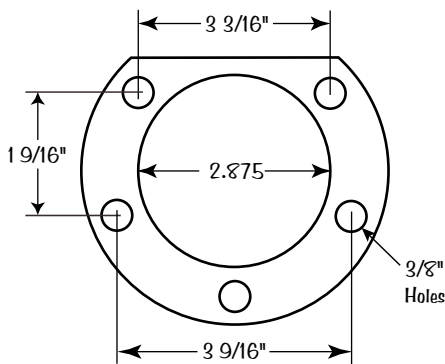

57-64 Olds/Pontiac

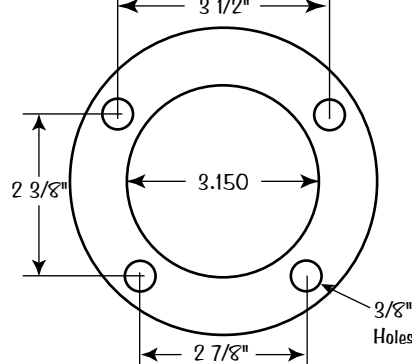

64 & up Buick/Olds/Pontiac

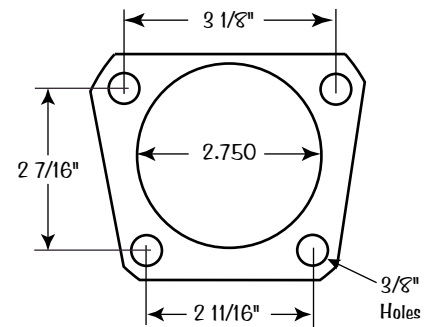

TJ

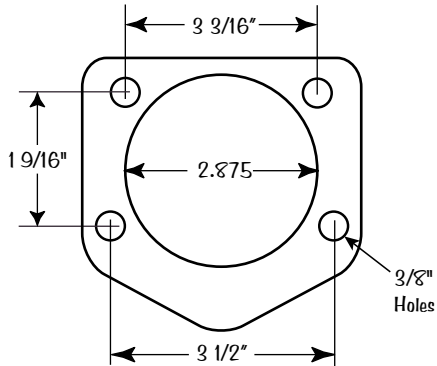

Jeep CJ

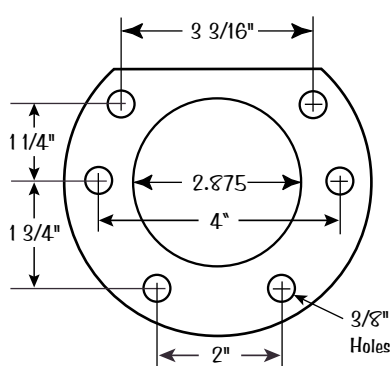

Wagoneer / YJ

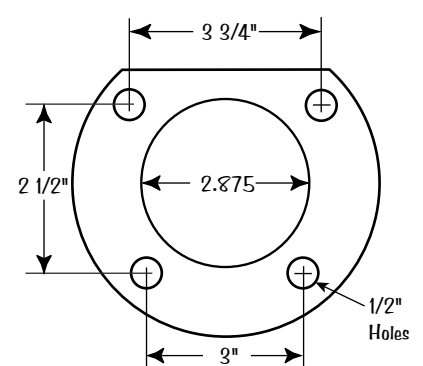

55-56 Chevy Belair

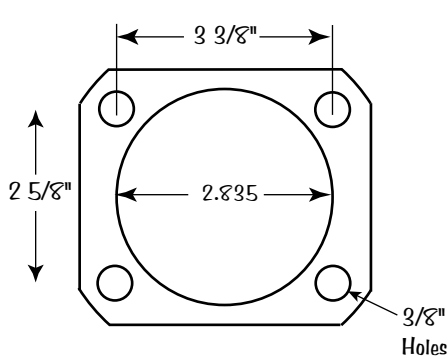

57-64 Chevy Belair/Impala

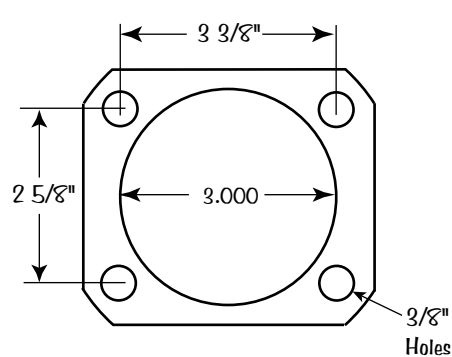

Wagoneer

